

NORTH TARRANT EXPRESS SEGMENT 3B PROPOSAL SCHEMATIC PLAN SET

JULY 08, 2010

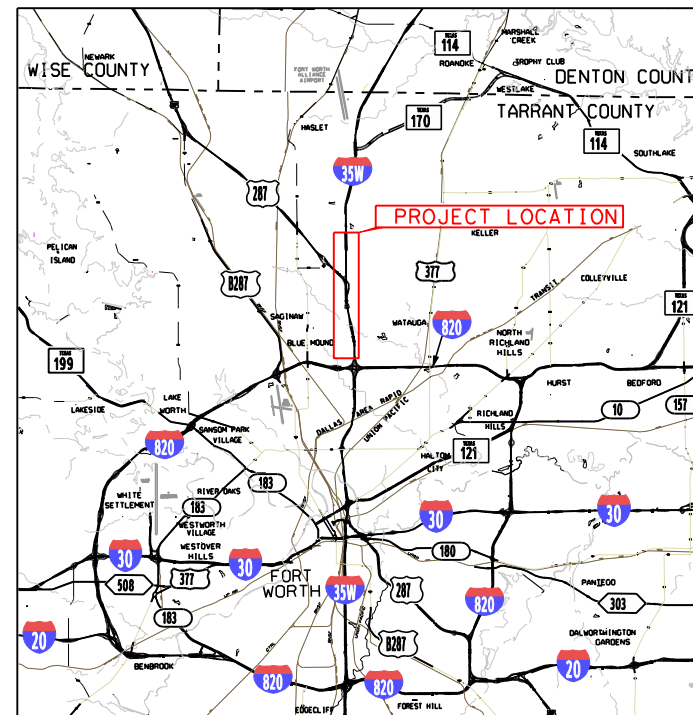

Location / Key Map

<u>ROADWAY</u>	<u>DESIGN SPEED</u>
GENERAL PURPOSE.....	70 MPH
MANAGED LANES.....	70 MPH
FRONTAGE ROADS.....	40 MPH
RAMPS/COLLECTORS.....	50 MPH
CROSS (CITY STREET).....	35 MPH

INDEX OF SHEETS

<u>SHEET NO.</u>	<u>DESCRIPTION</u>
1	COVER SHEET
ROADWAY 2-12	IH 35W PLAN
13-14	US 287 PLAN

ROADWAY TYPICAL SECTIONS ARE PROVIDED ON ROLL SHEETS.

1 ROLL	TYPICAL SECTIONS
--------	------------------

ALL DESIGN VALUES HAVE BEEN MET PER THE REQUIREMENTS OF THE NORTH TARRANT EXPRESS MDP CDA GEOMETRIC DESIGN CRITERIA INCLUDING THE NOTES OF GEOMETRIC DEVIATIONS WITHIN THE SAME DOCUMENT, ALONG WITH ALL THE RFI'S SUBMITTED TO TxDOT DURING THE MASTER DEVELOPMENT AGREEMENT FOR THIS SEGMENT.



NOTE:

1. THE PROPOSAL SCHEMATICS ARE PRELIMINARY AND SUBJECT TO CHANGE. THE LOCATION OF ALL BRIDGE BENTS AND ABUTMENTS IS PRELIMINARY AND SUBJECT TO MODIFICATION DURING DETAIL DESIGN PHASE. ALL MODIFICATIONS WILL BE WITHIN THE STRUCTURAL REQUIREMENTS STATED ON CDA FOR SEGMENTS 2-4 BOOK 3. THE LOCATION OF ALL RETAINING WALLS IS PRELIMINARY AND SUBJECT TO MODIFICATION DURING DETAIL DESIGN PHASE.



AECOM Technical Services Inc. - 3580

REV	DATE	BY	DESCRIPTION

LEGEND

- PROPOSED MAINLANES
- PROPOSED MANAGED LANES
- PROPOSED FRONTAGE ROADS / SURFACE STREET
- PROPOSED DIRECT CONNECTOR / PROPOSED RAMP
- PROPOSED SHOULDERS
- POTENTIAL DISPLACEMENTS
- PROPOSED GORE
- PREVIOUS CONSTRUCTION BY OTHERS
- PROPOSED RETAINING WALL
- PROPOSED NOISE WALL
- PROPOSED CONTROL-OF-ACCESS
- EXISTING RIGHT-OF-WAY
- PROPOSED RIGHT-OF-WAY (ACCESS RESTRICTED)
- PROPOSED DRAINAGE EASEMENT
- ADDITIONAL RIGHT-OF-WAY
- STRUCTURE LIMITS AND BENTS / COLUMNS PROPOSED STRUCTURE
- SIDEWALK
- EXISTING PAVEMENT REMOVAL
- TRAFFIC DIRECTION
- T MANAGED LANE TOLL GANTRY
- T RAMP TOLL GANTRY
- HOV DECLARATION AREA
- 170W35S ALIGNMENT NAME
- BRIDGE IDENTIFIER
- PROPOSED MANAGED LANE OVERLAY

SEG3B

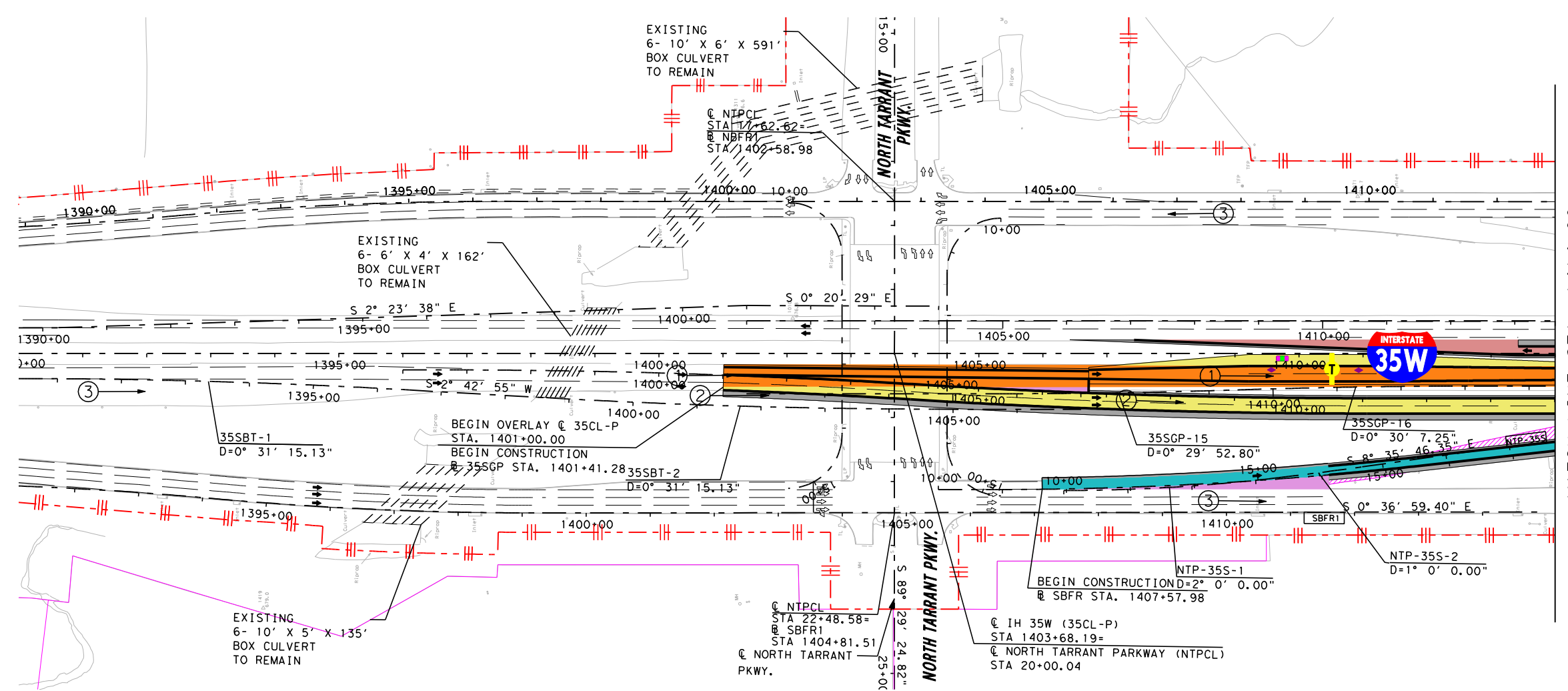
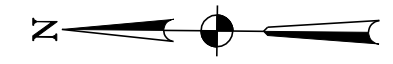

PRELIMINARY

north tarrant
express

AECOM
AECOM Technical Services Inc. - 3580

THIS DOCUMENT IS RELEASED UNDER THE AUTHORITY OF:
Fernando Gaytán, P.E.
TEXAS REGISTRATION NO: 92244
DATE: 7/8/2010
NOT TO BE USED FOR CONSTRUCTION, OR PERMIT PURPOSES.

NORTH TARRANT EXPRESS - SEGMENT 3B

IH 35W PLAN

HORIZ.: 1" = 200' SHEET 1 OF 9

FED. RD. DIV. NO.	PROJECT NUMBER	SHEET NO.
STATE	DISTRICT	COUNTY
TEXAS		TARRANT
CONT	SECT	JOB
		HIGHWAY NO
		IH 35W

L:\work\Trans\112671 NTEX\CADD (Segment 3A and 3B)\Seg3B\Sheets Inter\m11x17\PLAN VIEW ONLY SHEETS FOR 051710 SUBMITTAL\Seg3B1+Schem+PLAN*01.dgn 7/8/2010 4:22:20 PM

REV	DATE	BY	DESCRIPTION

LEGEND

- PROPOSED MAINLANES
- PROPOSED MANAGED LANES
- PROPOSED FRONTAGE ROADS / SURFACE STREET
- PROPOSED DIRECT CONNECTOR / PROPOSED RAMP
- PROPOSED SHOULDERS
- POTENTIAL DISPLACEMENTS
- PROPOSED GORE
- PREVIOUS CONSTRUCTION BY OTHERS
- PROPOSED RETAINING WALL
- PROPOSED NOISE WALL
- PROPOSED CONTROL-OF-ACCESS
- EXISTING RIGHT-OF-WAY
- PROPOSED RIGHT-OF-WAY (ACCESS RESTRICTED)
- PROPOSED DRAINAGE EASEMENT
- ADDITIONAL RIGHT-OF-WAY
- STRUCTURE LIMITS AND BENTS / COLUMNS PROPOSED STRUCTURE
- SIDEWALK
- EXISTING PAVEMENT REMOVAL
- TRAFFIC DIRECTION
- MANAGED LANE TOLL GANTRY
- RAMP TOLL GANTRY
- HOV DECLARATION AREA
- ALIGNMENT NAME
- BRIDGE IDENTIFIER
- PROPOSED MANAGED LANE OVERLAY

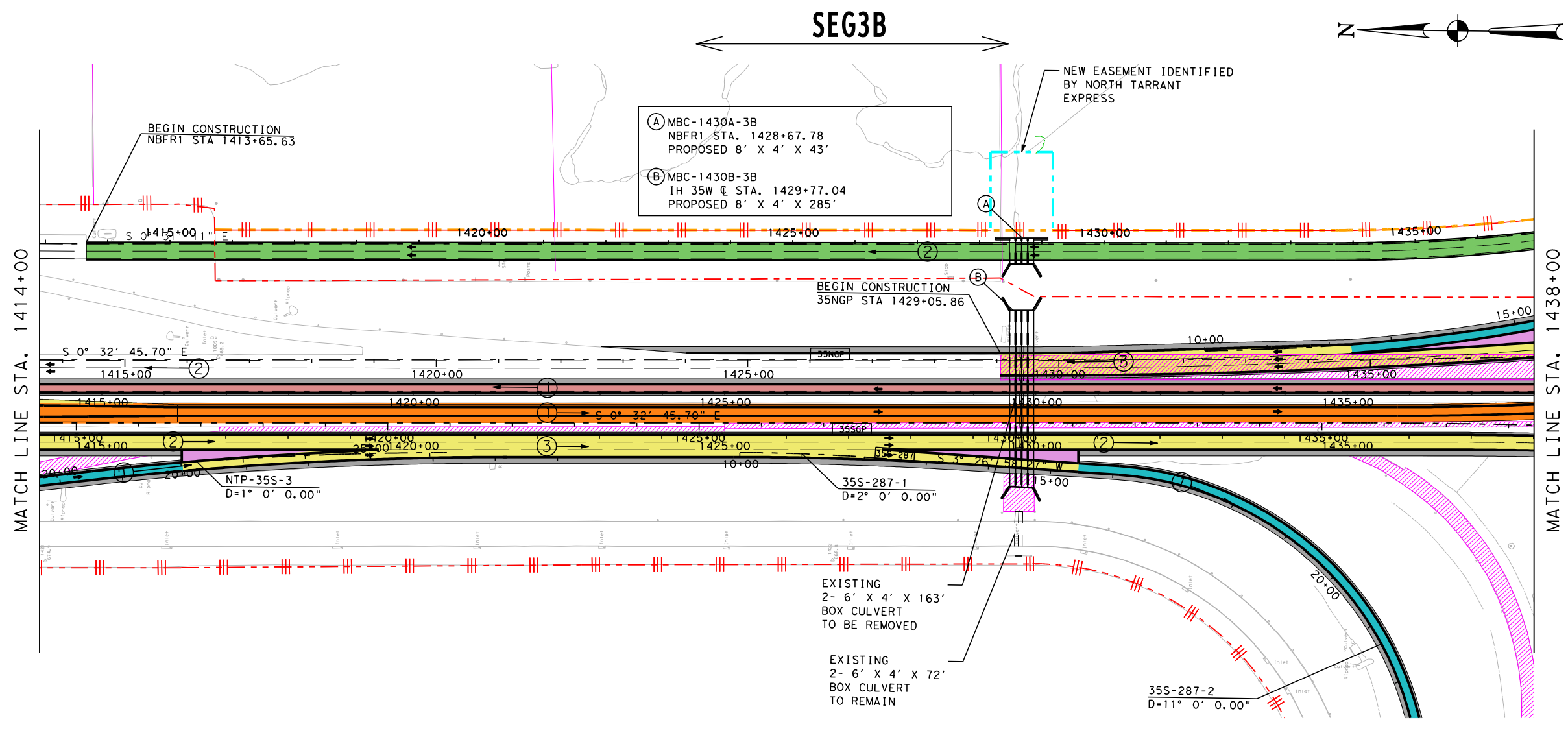
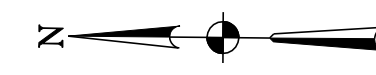

(A) MBC-1430A-3B
 NBFRT STA. 1428+67.78
 PROPOSED 8' X 4' X 43'
 (B) MBC-1430B-3B
 IH 35W C STA. 1429+77.04
 PROPOSED 8' X 4' X 285'

NOTE:
 CURVE 35S-287-2 SHALL HAVE A DESIGN SPEED OF 40 MPH AS
 REQUIRED BY THE NORTH TARRANT EXPRESS MDP CDA
 GEOMETRIC DESIGN CRITERIA NOTE 19.

PRELIMINARY

AECOM

AECOM Technical Services Inc. - 3580

THIS DOCUMENT IS RELEASED UNDER THE AUTHORITY OF:
 Fernando Gaytán, P.E.
 TEXAS REGISTRATION NO: 92244
 DATE: 7/8/2010
 NOT TO BE USED FOR CONSTRUCTION, OR PERMIT PURPOSES.

NORTH TARRANT EXPRESS - SEGMENT 3B
 IH 35W
 PLAN

HORZ.: 1" = 200' SHEET 2 OF 9

FED. RD. DIV. NO.	PROJECT NUMBER	SHEET NO.
STATE	DISTRICT	COUNTY
TEXAS		TARRANT
CONT	SECT	JOB
		HIGHWAY NO
		IH 35W

L:\work\Trans\112671 NTE\CADD (Segment 3A and 3B)\Seg3B\Sheets Inter\mplan view only sheets for 070810 SUBMITTAL\Seg3B1*Schem*PLAN*02.dgn 7/8/2010 7:43:56 PM

REV	DATE	BY	DESCRIPTION

LEGEND

- PROPOSED MAINLANES
- PROPOSED MANAGED LANES
- PROPOSED FRONTAGE ROADS / SURFACE STREET
- PROPOSED DIRECT CONNECTOR / PROPOSED RAMP
- PROPOSED SHOULDERS
- POTENTIAL DISPLACEMENTS
- PROPOSED GORE
- PREVIOUS CONSTRUCTION BY OTHERS
- PROPOSED RETAINING WALL
- PROPOSED NOISE WALL
- PROPOSED CONTROL-OF-ACCESS
- EXISTING RIGHT-OF-WAY
- PROPOSED RIGHT-OF-WAY (ACCESS RESTRICTED)
- PROPOSED DRAINAGE EASEMENT
- ADDITIONAL RIGHT-OF-WAY
- STRUCTURE LIMITS AND BENTS / COLUMNS
- PROPOSED STRUCTURE
- SIDEWALK
- EXISTING PAVEMENT REMOVAL
- TRAFFIC DIRECTION
- MANAGED LANE TOLL GANTRY
- RAMP TOLL GANTRY
- HOV DECLARATION AREA
- ALIGNMENT NAME
- BRIDGE IDENTIFIER
- PROPOSED MANAGED LANE OVERLAY

SEG3B

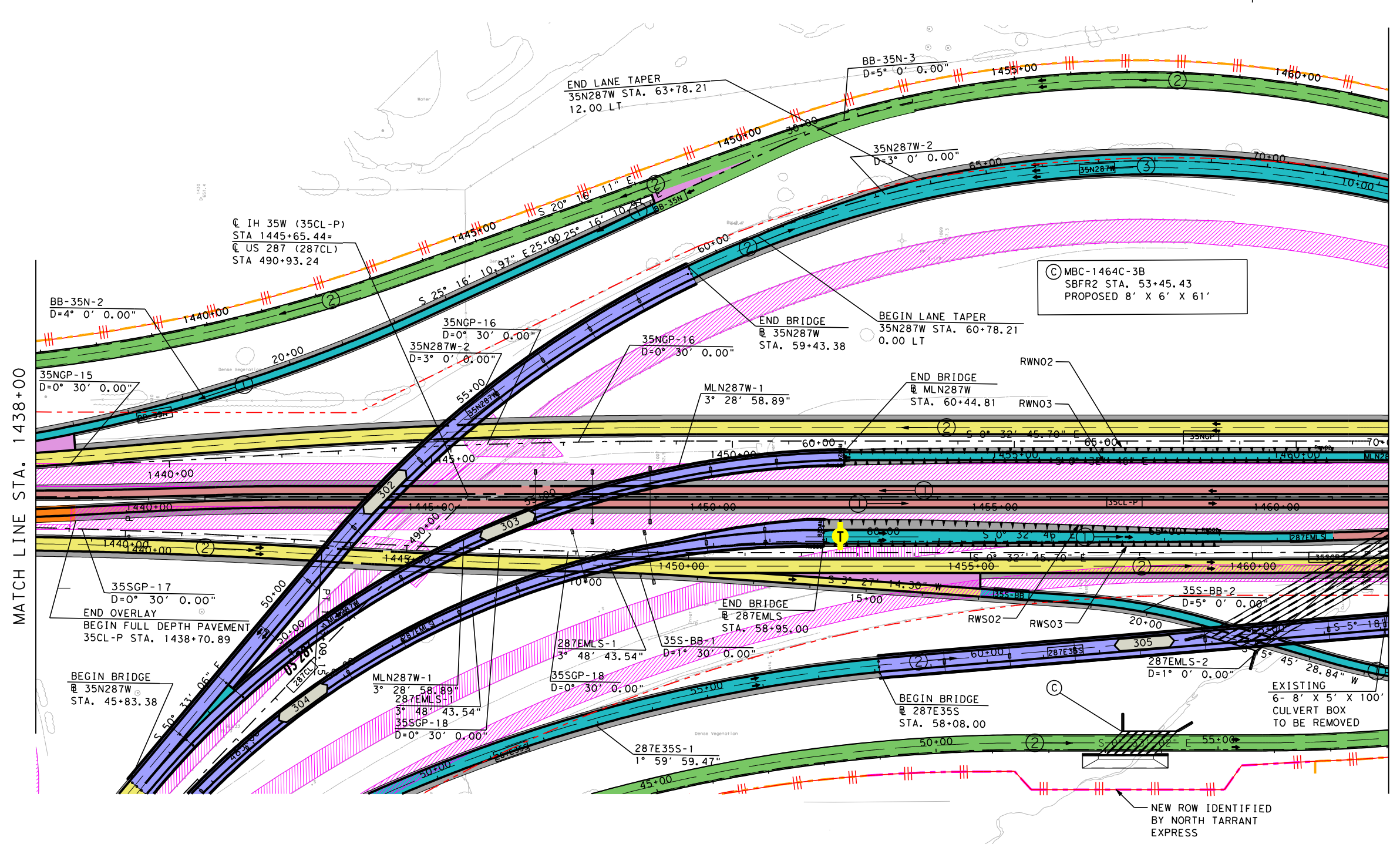
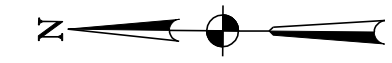

MATCH LINE STA. 1438+00

MATCH LINE STA. 1462+00

PRELIMINARY

north tarrant
express

AECOM
AECOM Technical Services Inc. - 3580

THIS DOCUMENT IS RELEASED UNDER THE AUTHORITY OF:
Fernando Gaytán, P.E.
TEXAS REGISTRATION NO: 92244
DATE: 7/8/2010
NOT TO BE USED FOR CONSTRUCTION, OR PERMIT PURPOSES.

NORTH TARRANT EXPRESS - SEGMENT 3B

IH 35W
PLAN

HORZ.: 1" = 200'

SHEET 3 OF 9

FED. RD. DIV. NO.	PROJECT NUMBER	SHEET NO.
STATE	DISTRICT	COUNTY
TEXAS	TARRANT	
CONT	SECT	JOB
		HIGHWAY NO
		IH 35W

L:\work\Trans\112671 NTE\CADD (Segment 3A and 3B)\Seg3B\Sheets Interim\11x17\PLAN VIEW ONLY SHEETS FOR 051710 SUBMITTAL\Seg3B1*Scheme*PLAN*03.dgn 7/8/2010 4:23:29 PM

REV	DATE	BY	DESCRIPTION

LEGEND

- PROPOSED MAINLANES
- PROPOSED MANAGED LANES
- PROPOSED FRONTAGE ROADS / SURFACE STREET
- PROPOSED DIRECT CONNECTOR / PROPOSED RAMP
- PROPOSED SHOULDERS
- POTENTIAL DISPLACEMENTS
- PROPOSED GORE
- PREVIOUS CONSTRUCTION BY OTHERS
- PROPOSED RETAINING WALL
- PROPOSED NOISE WALL
- PROPOSED CONTROL-OF-ACCESS
- EXISTING RIGHT-OF-WAY
- PROPOSED RIGHT-OF-WAY (ACCESS RESTRICTED)
- PROPOSED DRAINAGE EASEMENT
- ADDITIONAL RIGHT-OF-WAY
- STRUCTURE LIMITS AND BENTS / COLUMNS PROPOSED STRUCTURE
- SIDEWALK
- EXISTING PAVEMENT REMOVAL
- TRAFFIC DIRECTION
- MANAGED LANE TOLL GANTRY
- RAMP TOLL GANTRY
- HOV DECLARATION AREA
- 170W35S ALIGNMENT NAME
- BRIDGE IDENTIFIER

SEG3B

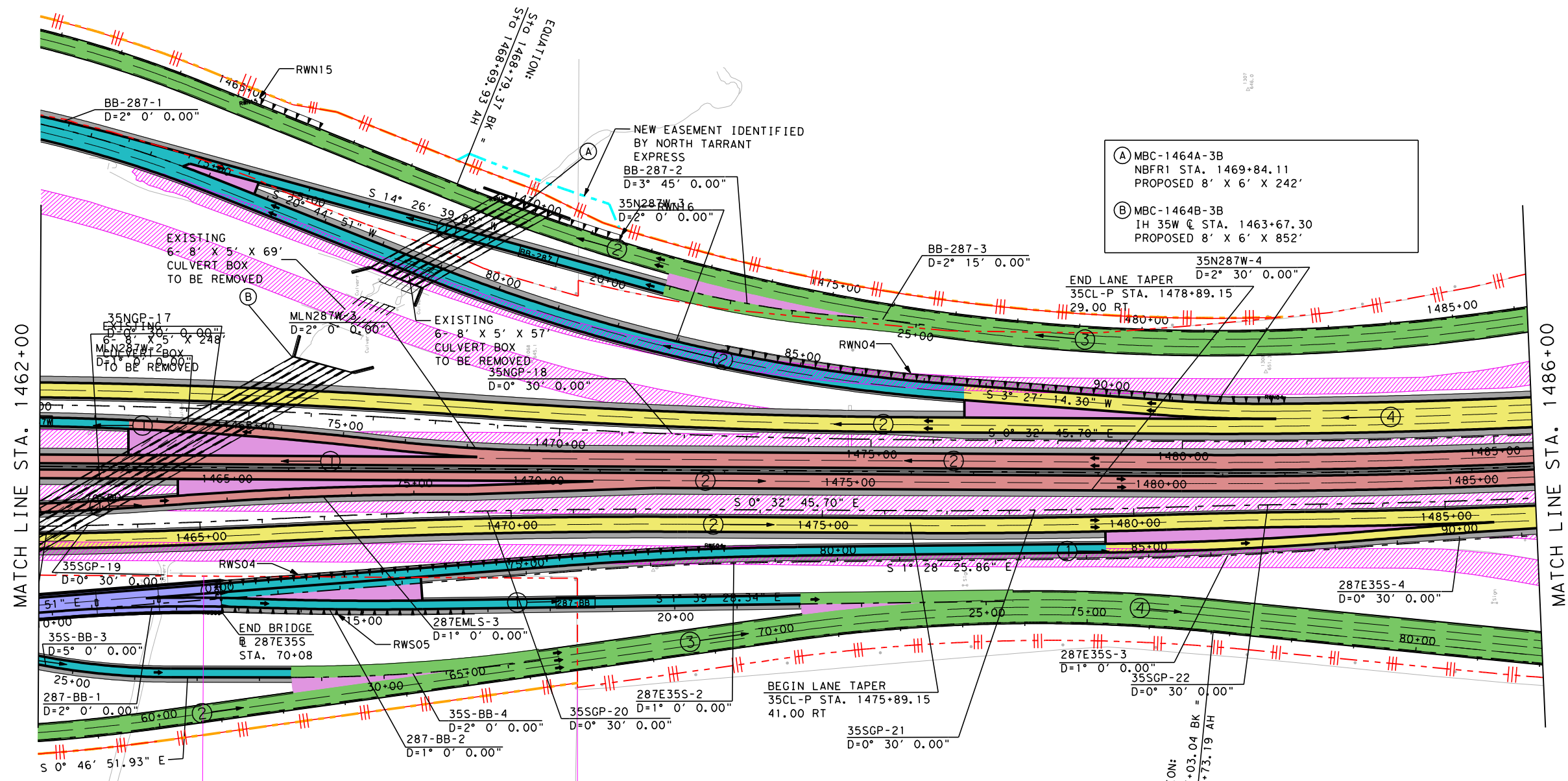
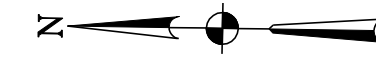

MATCH LINE STA. 1462+00

MATCH LINE STA. 1486+00

PRELIMINARY

north tarrant
express

AECOM
AECOM Technical Services Inc. - 3580

THIS DOCUMENT IS RELEASED UNDER THE AUTHORITY OF:
Fernando Gaytán, P.E.
TEXAS REGISTRATION NO: 92244
DATE: 7/8/2010
NOT TO BE USED FOR CONSTRUCTION, OR PERMIT PURPOSES.

NORTH TARRANT EXPRESS - SEGMENT 3B

IH 35W

PLAN

HORZ.: 1" = 200' SHEET 4 OF 9

FED. RD. DIV. NO.	PROJECT NUMBER	COUNTY	SHEET NO.
STATE	DISTRICT	TARRANT	
TEXAS	SECT	JOB	HIGHWAY NO
			IH 35W

L:\work\Trans\112671 NTEX\CADD (Segment 3A and 3B)\Seg3B\Sheets Interim\112671PLAN VIEW ONLY SHEETS FOR 051710 SUBMITTAL\Seg3B1+Schem+PLAN*04.dgn 7/8/2010 4:36:54 PM

REV	DATE	BY	DESCRIPTION

LEGEND

- PROPOSED MAINLANES
- PROPOSED MANAGED LANES
- PROPOSED FRONTAGE ROADS / SURFACE STREET
- PROPOSED DIRECT CONNECTOR / PROPOSED RAMP
- PROPOSED SHOULDERS
- POTENTIAL DISPLACEMENTS
- PROPOSED GORE
- PREVIOUS CONSTRUCTION BY OTHERS
- PROPOSED RETAINING WALL
- PROPOSED NOISE WALL
- PROPOSED CONTROL-OF-ACCESS
- EXISTING RIGHT-OF-WAY
- PROPOSED RIGHT-OF-WAY (ACCESS RESTRICTED)
- PROPOSED DRAINAGE EASEMENT
- ADDITIONAL RIGHT-OF-WAY
- STRUCTURE LIMITS AND BENTS / COLUMNS PROPOSED STRUCTURE
- SIDEWALK
- EXISTING PAVEMENT REMOVAL
- TRAFFIC DIRECTION
- T MANAGED LANE TOLL GANTRY
- T RAMP TOLL GANTRY
- HOV DECLARATION AREA
- 170W35S ALIGNMENT NAME
- BRIDGE IDENTIFIER

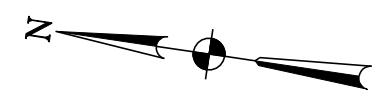

SEG3B

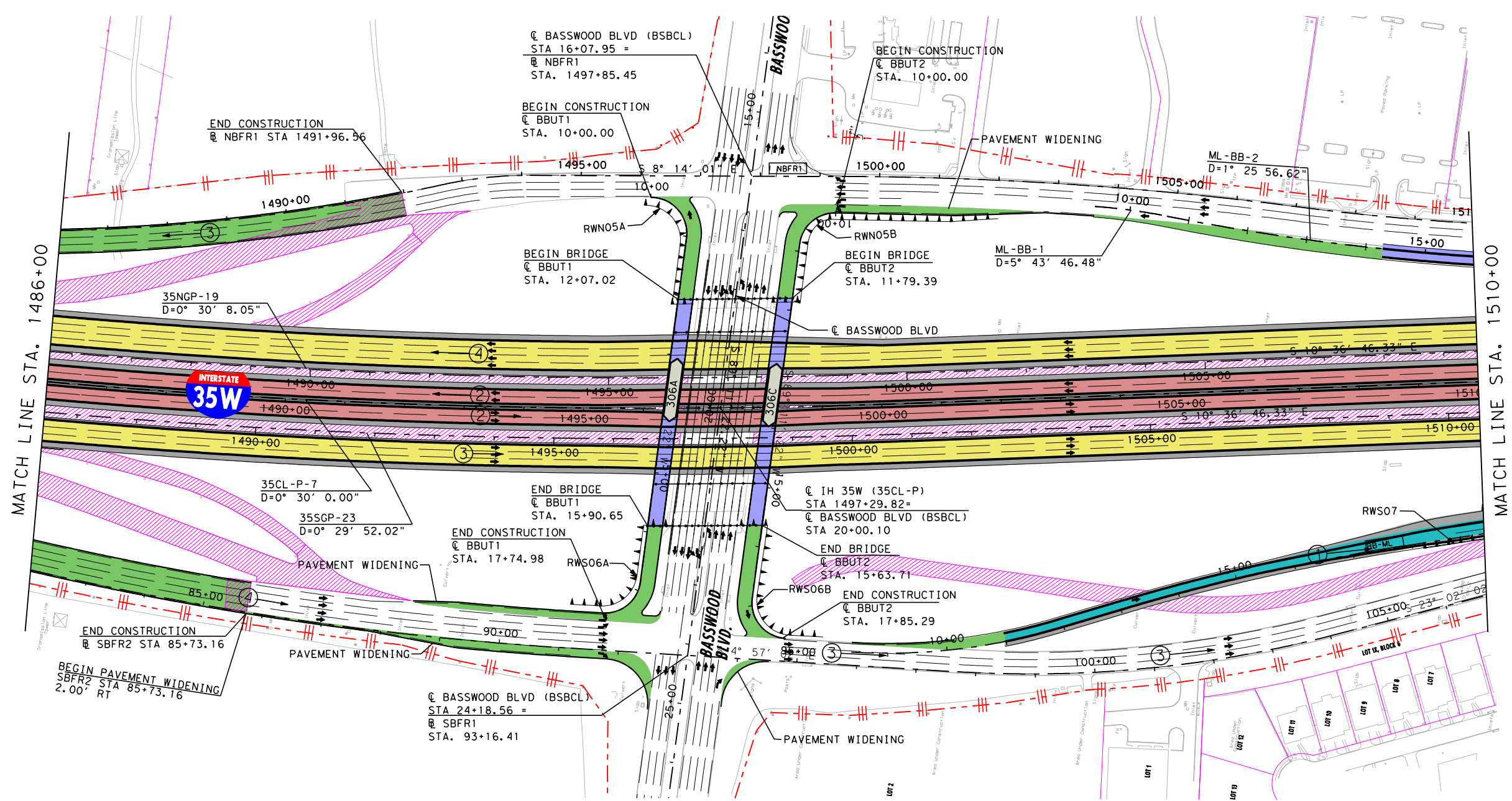

MATCH LINE STA. 1486+00

MATCH LINE STA. 1510+00

NOTE:
 INTERIM IH-35W CONFIGURATION MODIFIED TO FIT UNDER EXISTING BASSWOOD BLVD. OVERPASS. EXISTING BASSWOOD BLVD. BRIDGE WILL BE PRESERVED IN ITS EXISTING CONFIGURATION

PRELIMINARY

north tarrant
express

AECOM

AECOM Technical Services Inc. - 3580

THIS DOCUMENT IS RELEASED UNDER THE AUTHORITY OF:
 Fernando Gaytán, P.E.
 TEXAS REGISTRATION NO: 92244
 DATE: 7/8/2010
 NOT TO BE USED FOR CONSTRUCTION, OR PERMIT PURPOSES.

NORTH TARRANT EXPRESS - SEGMENT 3B

IH 35W
PLAN

HORZ.: 1" = 200' SHEET 5 OF 9

FED. RD. DIV. NO.	PROJECT NUMBER	SHEET NO.	
STATE	DISTRICT	COUNTY	
TEXAS		TARRANT	
CONT	SECT	JOB	HIGHWAY NO
			IH 35W

L:\work\Trans\112671 NTE\CADD (Segment 3A and 3B)\Seg3B\Sheets Inter\m11x17\PLAN VIEW ONLY SHEETS FOR 051710 SUBMITTAL\Seg3B1+Schem+PLAN*05.dgn 7/8/2010 4:24:30 PM

REV	DATE	BY	DESCRIPTION

LEGEND

- PROPOSED MAINLANES
- PROPOSED MANAGED LANES
- PROPOSED FRONTAGE ROADS / SURFACE STREET
- PROPOSED DIRECT CONNECTOR / PROPOSED RAMP
- PROPOSED SHOULDERS
- POTENTIAL DISPLACEMENTS
- PROPOSED GORE
- PREVIOUS CONSTRUCTION BY OTHERS
- PROPOSED RETAINING WALL
- PROPOSED NOISE WALL
- PROPOSED CONTROL-OF-ACCESS
- EXISTING RIGHT-OF-WAY
- PROPOSED RIGHT-OF-WAY (ACCESS RESTRICTED)
- PROPOSED DRAINAGE EASEMENT
- ADDITIONAL RIGHT-OF-WAY
- STRUCTURE LIMITS AND BENTS / COLUMNS PROPOSED STRUCTURE
- SIDEWALK
- EXISTING PAVEMENT REMOVAL
- TRAFFIC DIRECTION
- MANAGED LANE TOLL GANTRY
- RAMP TOLL GANTRY
- HOV DECLARATION AREA
- ALIGNMENT NAME
- BRIDGE IDENTIFIER

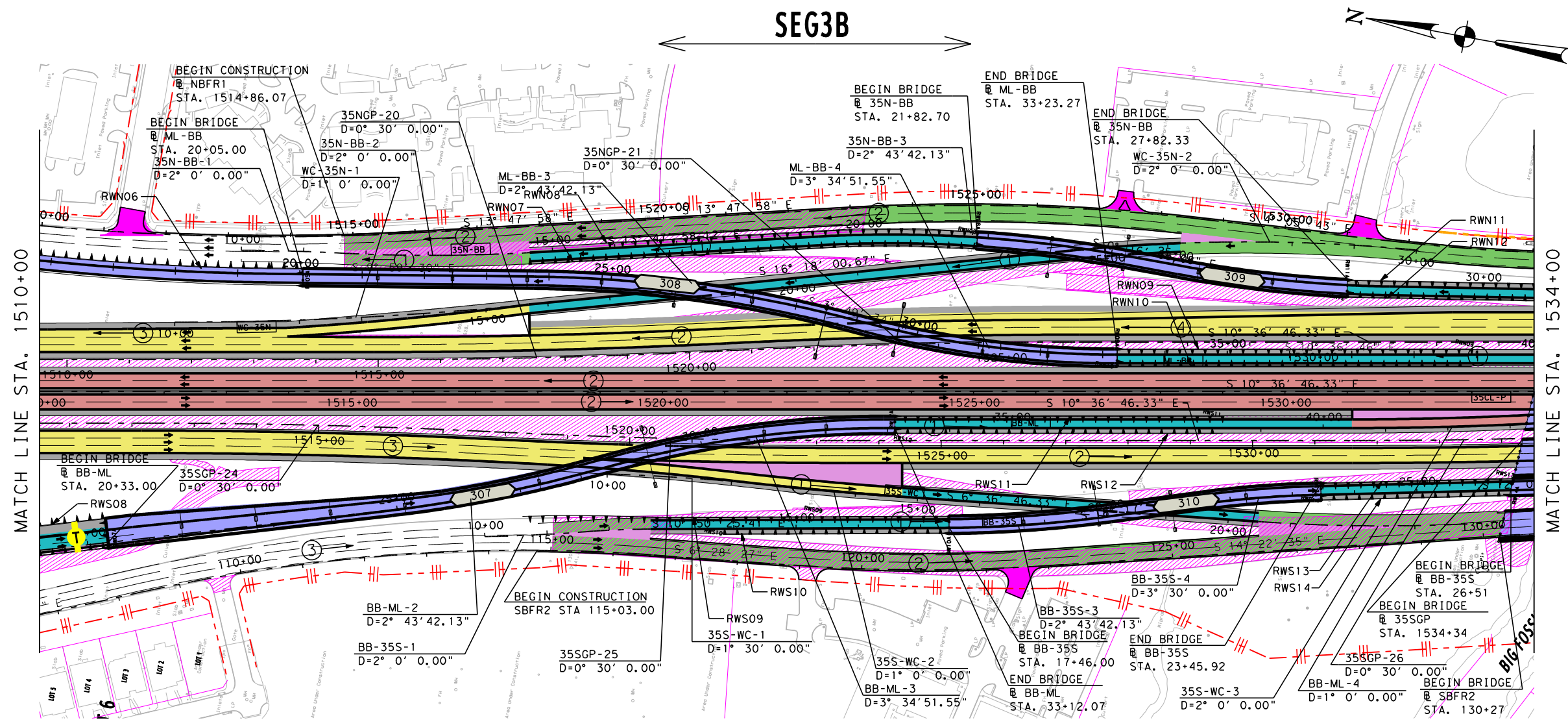

PRELIMINARY

north tarrant
express

AECOM

AECOM Technical Services Inc. - 3580

THIS DOCUMENT IS RELEASED UNDER THE AUTHORITY OF:
Fernando Gaytán, P.E.
TEXAS REGISTRATION NO: 92244
DATE: 7/8/2010
NOT TO BE USED FOR CONSTRUCTION, OR PERMIT PURPOSES.

NORTH TARRANT EXPRESS - SEGMENT 3B

IH 35W
PLAN

HORZ.: 1" = 200' SHEET 6 OF 9

FED. RD. DIV. NO.	PROJECT NUMBER	SHEET NO.
STATE	DISTRICT	COUNTY
TEXAS		TARRANT
CONT	SECT	JOB
		HIGHWAY NO
		IH 35W

L:\work\Trans\112671 NTEXCAD (Segment 3A and 3B)\Seg3B\Sheets Interim\112671 PLAN VIEW ONLY SHEETS FOR 051710 SUBMITTAL\Seg3B1+Schem+PLAN*06.dgn 7/8/2010 4:24:53 PM

REV	DATE	BY	DESCRIPTION

LEGEND

- PROPOSED MAINLANES
- PROPOSED MANAGED LANES
- PROPOSED FRONTAGE ROADS / SURFACE STREET
- PROPOSED DIRECT CONNECTOR / PROPOSED RAMP
- PROPOSED SHOULDERS
- POTENTIAL DISPLACEMENTS
- PROPOSED GORE
- PREVIOUS CONSTRUCTION BY OTHERS
- PROPOSED RETAINING WALL
- PROPOSED NOISE WALL
- PROPOSED CONTROL-OF-ACCESS
- EXISTING RIGHT-OF-WAY
- PROPOSED RIGHT-OF-WAY (ACCESS RESTRICTED)
- PROPOSED DRAINAGE EASEMENT
- ADDITIONAL RIGHT-OF-WAY
- STRUCTURE LIMITS AND BENTS / COLUMNS PROPOSED STRUCTURE
- SIDEWALK
- EXISTING PAVEMENT REMOVAL
- TRAFFIC DIRECTION
- MANAGED LANE TOLL GANTRY
- RAMP TOLL GANTRY
- HOV DECLARATION AREA
- ALIGNMENT NAME
- BRIDGE IDENTIFIER

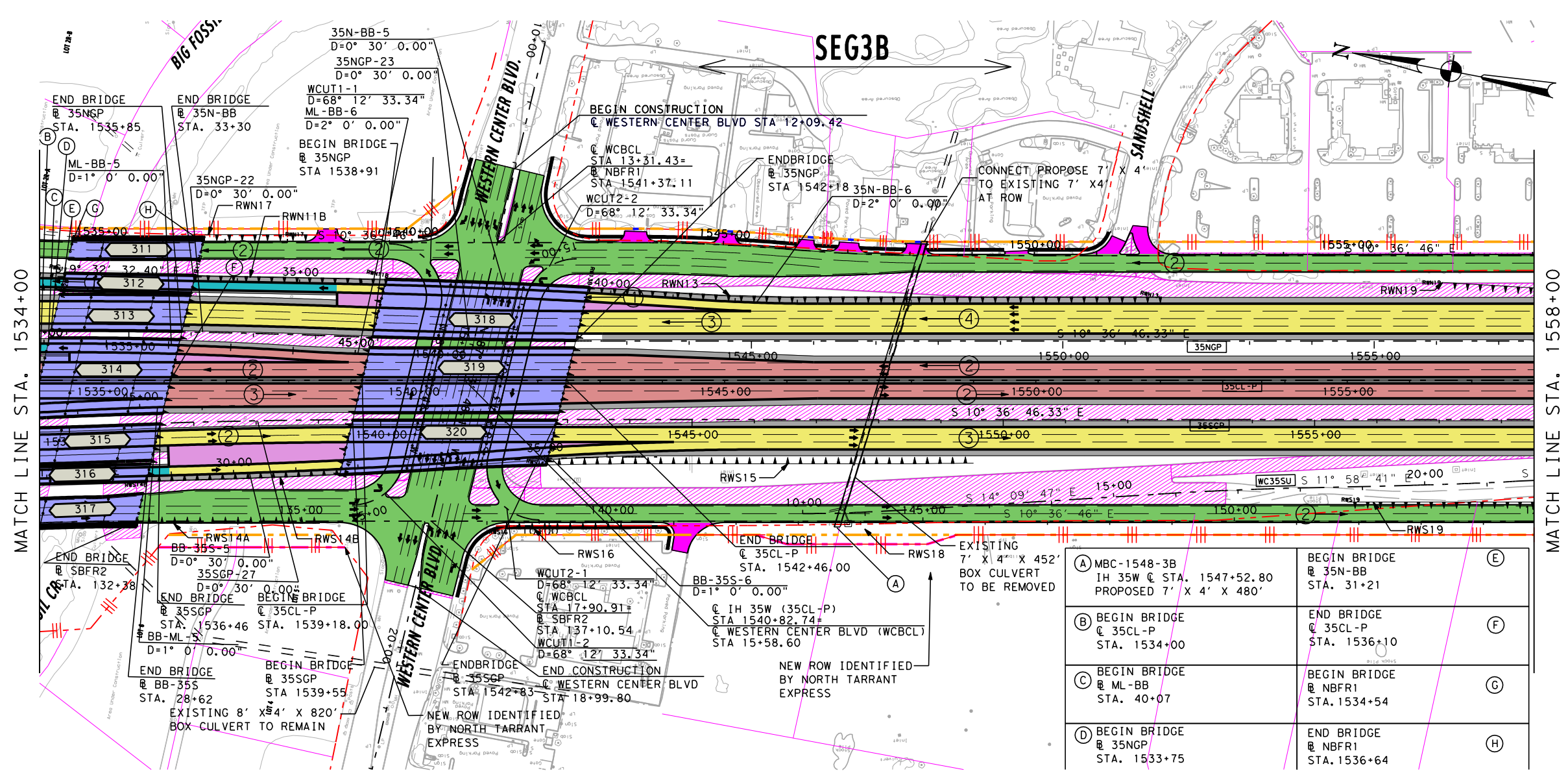

MATCH LINE STA. 1534+00

MATCH LINE STA. 1558+00

(A) MBC-1548-3B IH 35W @ STA. 1547+52.80 PROPOSED 7' X 4' X 480'	BEGIN BRIDGE @ 35N-BB STA. 31+21	(E)
(B) BEGIN BRIDGE @ 35CL-P STA. 1534+00	END BRIDGE @ 35CL-P STA. 1536+10	(F)
(C) BEGIN BRIDGE @ ML-BB STA. 40+07	BEGIN BRIDGE @ NBFRI STA. 1534+54	(G)
(D) BEGIN BRIDGE @ 35NGP STA. 1533+75	END BRIDGE @ NBFRI STA. 1536+64	(H)

NOTE:
SHEET 7 OF 9 APPLICABLE
ONLY WITH NTE OPTIMIZED
INTERCHANGE OPTION

PRELIMINARY

north tarrant
express

AECOM
AECOM Technical Services Inc. - 3580

THIS DOCUMENT IS RELEASED UNDER THE AUTHORITY OF:
Fernando Gaytán, P.E.
TEXAS REGISTRATION NO: 92244
DATE: 7/8/2010
NOT TO BE USED FOR CONSTRUCTION, OR PERMIT PURPOSES.

NORTH TARRANT EXPRESS - SEGMENT 3B

IH 35W PLAN

HORZ.: 1" = 200' SHEET 7 OF 9

STATE	DISTRICT	COUNTY	
TEXAS		TARRANT	
CONT	SECT	JOB	HIGHWAY NO
			IH 35W

L:\work\Trans\112671 NTE\CADD (Segment 3A and 3B)\Seg3B\Sheets Inter\PLAN VIEW ONLY SHEETS FOR 070810 SUBMITTAL\Seg3B1*Scheme\PLAN07.dwg 7/8/2010 8:13:00 PM

REV	DATE	BY	DESCRIPTION

LEGEND

- PROPOSED MAINLANES
- PROPOSED MANAGED LANES
- PROPOSED FRONTAGE ROADS / SURFACE STREET
- PROPOSED DIRECT CONNECTOR / PROPOSED RAMP
- PROPOSED SHOULDERS
- POTENTIAL DISPLACEMENTS
- PROPOSED GORE
- PREVIOUS CONSTRUCTION BY OTHERS
- PROPOSED RETAINING WALL
- PROPOSED NOISE WALL
- PROPOSED CONTROL-OF-ACCESS
- EXISTING RIGHT-OF-WAY
- PROPOSED RIGHT-OF-WAY (ACCESS RESTRICTED)
- PROPOSED DRAINAGE EASEMENT
- ADDITIONAL RIGHT-OF-WAY
- STRUCTURE LIMITS AND BENTS / COLUMNS PROPOSED STRUCTURE
- SIDEWALK
- EXISTING PAVEMENT REMOVAL
- TRAFFIC DIRECTION
- T MANAGED LANE TOLL GANTRY
- T RAMP TOLL GANTRY
- HOV DECLARATION AREA
- 170W35S ALIGNMENT NAME
- 311 BRIDGE IDENTIFIER

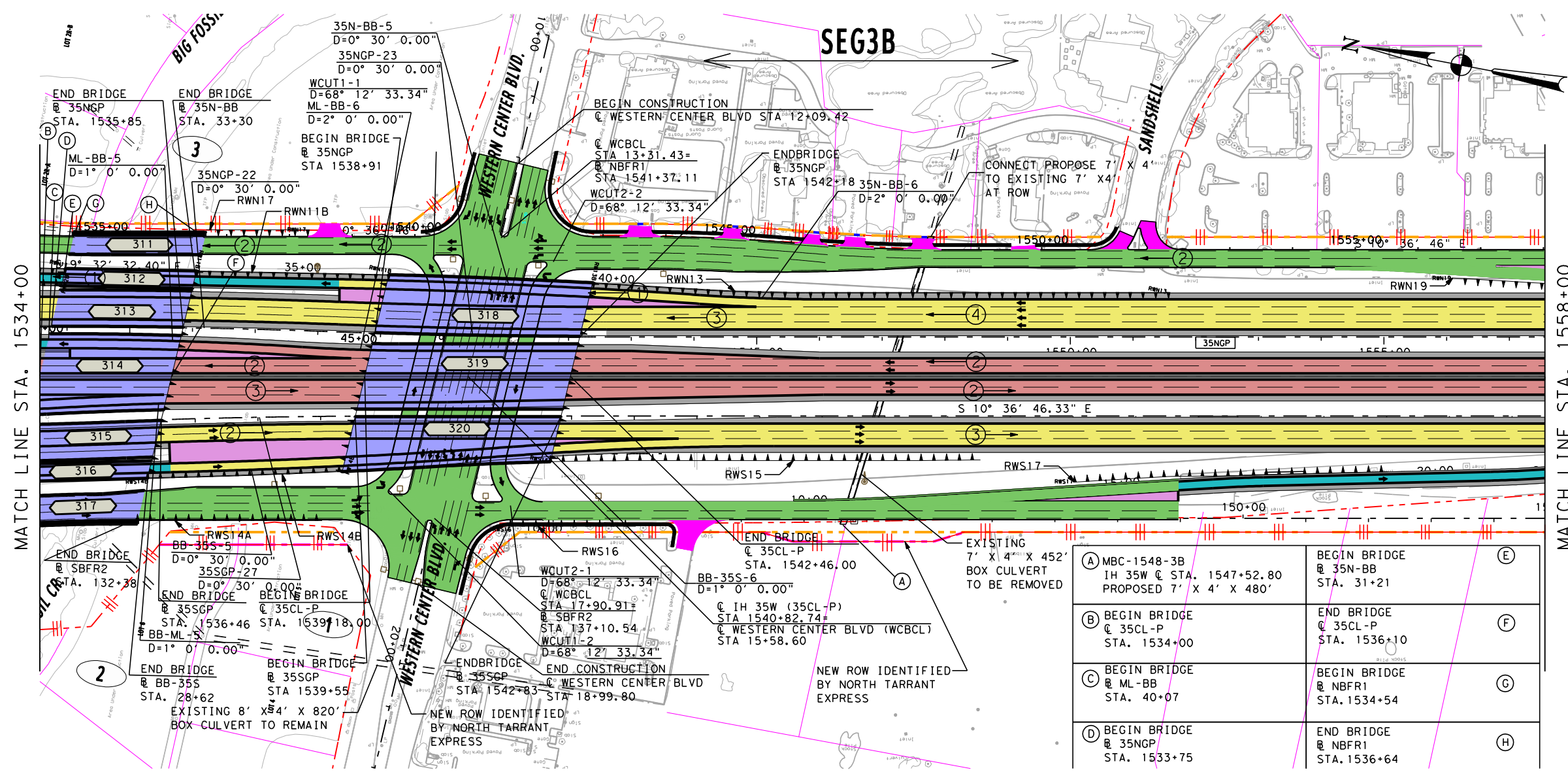

(A) MBC-1548-3B IH 35W @ STA. 1547+52.80 PROPOSED 7' X 4' X 480'	BEGIN BRIDGE @ 35N-BB STA. 31+21	(E)
(B) BEGIN BRIDGE @ 35CL-P STA. 1534+00	END BRIDGE @ 35CL-P STA. 1536+10	(F)
(C) BEGIN BRIDGE @ ML-BB STA. 40+07	BEGIN BRIDGE @ NBFRI STA. 1534+54	(G)
(D) BEGIN BRIDGE @ 35NGP STA. 1533+75	END BRIDGE @ NBFRI STA. 1536+64	(H)

NOTE:
SHEET 7A OF 9 APPLICABLE ONLY
WITH NTE INTERCHANGE OPTION B

PRELIMINARY

AECOM Technical Services Inc. - 3580

THIS DOCUMENT IS RELEASED UNDER THE AUTHORITY OF:
Fernando Gaytán, P.E.
TEXAS REGISTRATION NO: 92244
DATE: 7/9/2010
NOT TO BE USED FOR CONSTRUCTION, OR PERMIT PURPOSES.

NORTH TARRANT EXPRESS - SEGMENT 3B

IH 35W
PLAN

HORZ.: 1" = 200' SHEET 7A OF 9

FED. RD. DIV. NO.	PROJECT NUMBER	SHEET NO.	
STATE	DISTRICT	COUNTY	
TEXAS		TARRANT	
CONT	SECT	JOB	HIGHWAY NO
			IH 35W

L:\work\Trans\112671 NTE\CADD (Segment 3A and 3B)\Seg3B\Sheets Inter\mPLAN VIEW ONLY SHEETS FOR 070810 SUBMITTAL\Seg3B1*Scheme\PLAN07A.dgn 7/9/2010 9:44:07 AM

REV	DATE	BY	DESCRIPTION

LEGEND

- PROPOSED MAINLANES
- PROPOSED MANAGED LANES
- PROPOSED FRONTAGE ROADS / SURFACE STREET
- PROPOSED DIRECT CONNECTOR / PROPOSED RAMP
- PROPOSED SHOULDERS
- POTENTIAL DISPLACEMENTS
- PROPOSED GORE
- PREVIOUS CONSTRUCTION BY OTHERS
- PROPOSED RETAINING WALL
- PROPOSED NOISE WALL
- PROPOSED CONTROL-OF-ACCESS
- EXISTING RIGHT-OF-WAY
- PROPOSED RIGHT-OF-WAY (ACCESS RESTRICTED)
- PROPOSED DRAINAGE EASEMENT
- ADDITIONAL RIGHT-OF-WAY
- STRUCTURE LIMITS AND BENTS / COLUMNS PROPOSED STRUCTURE
- SIDEWALK
- EXISTING PAVEMENT REMOVAL
- TRAFFIC DIRECTION
- MANAGED LANE TOLL GANTRY
- RAMP TOLL GANTRY
- HOV DECLARATION AREA
- ALIGNMENT NAME
- BRIDGE IDENTIFIER

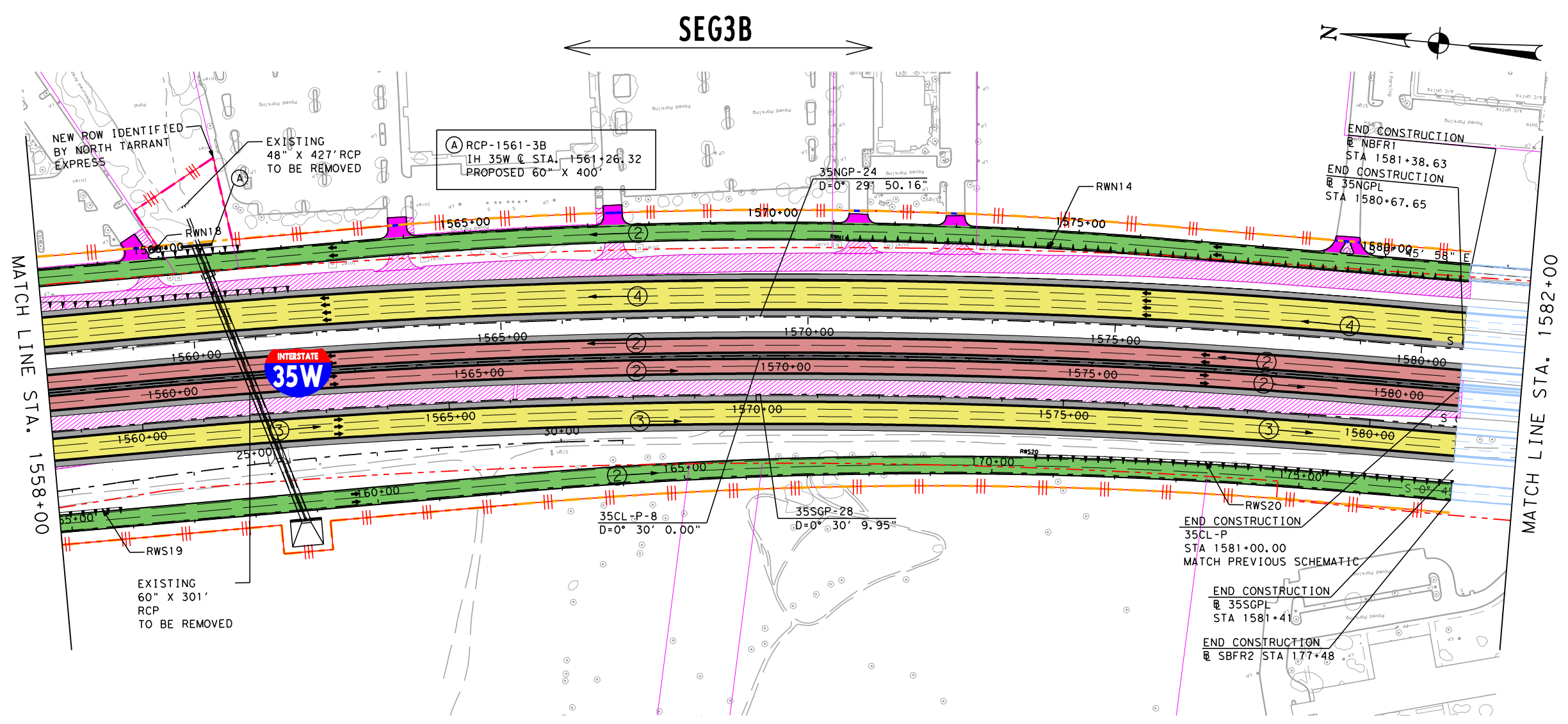

SEG3B

MATCH LINE STA. 1558+00

MATCH LINE STA. 1582+00



PRELIMINARY

north tarrant
express

AECOM
AECOM Technical Services Inc. - 3580

THIS DOCUMENT IS RELEASED UNDER THE AUTHORITY OF:
Fernando Gaytán, P.E.
TEXAS REGISTRATION NO: 92244
DATE: 7/8/2010
NOT TO BE USED FOR CONSTRUCTION, OR PERMIT PURPOSES.

NORTH TARRANT EXPRESS - SEGMENT 3B

IH 35W
PLAN

HORIZ.: 1" = 200' SHEET 8 OF 9

FED. RD. DIV. NO.	PROJECT NUMBER	SHEET NO.
STATE	DISTRICT	COUNTY
TEXAS		TARRANT
CONT	SECT	JOB
		HIGHWAY NO
		IH 35W

NOTE: SHEET 8 OF 9
APPLICABLE ONLY WITH NTE
OPTIMIZED INTERCHANGE OPTION

L:\work\Trans\112671 NTE\CADD (Segment 3A and 3B)\Seg3B\Sheets Inter\m\11x17\PLAN VIEW ONLY SHEETS FOR 051710 SUBMITTAL\Seg3B1+Schem\PLAN*08.dgn 7/8/2010 4:58:41 PM

REV	DATE	BY	DESCRIPTION

LEGEND

- PROPOSED MAINLANES
- PROPOSED MANAGED LANES
- PROPOSED FRONTAGE ROADS / SURFACE STREET
- PROPOSED DIRECT CONNECTOR / PROPOSED RAMP
- PROPOSED SHOULDERS
- POTENTIAL DISPLACEMENTS
- PROPOSED GORE
- PREVIOUS CONSTRUCTION BY OTHERS
- PROPOSED RETAINING WALL
- PROPOSED NOISE WALL
- PROPOSED CONTROL-OF-ACCESS
- EXISTING RIGHT-OF-WAY
- PROPOSED RIGHT-OF-WAY (ACCESS RESTRICTED)
- PROPOSED DRAINAGE EASEMENT
- ADDITIONAL RIGHT-OF-WAY
- STRUCTURE LIMITS AND BENTS / COLUMNS PROPOSED STRUCTURE
- SIDEWALK
- EXISTING PAVEMENT REMOVAL
- TRAFFIC DIRECTION
- MANAGED LANE TOLL GANTRY
- RAMP TOLL GANTRY
- HOV DECLARATION AREA
- 170W35S ALIGNMENT NAME
- BRIDGE IDENTIFIER

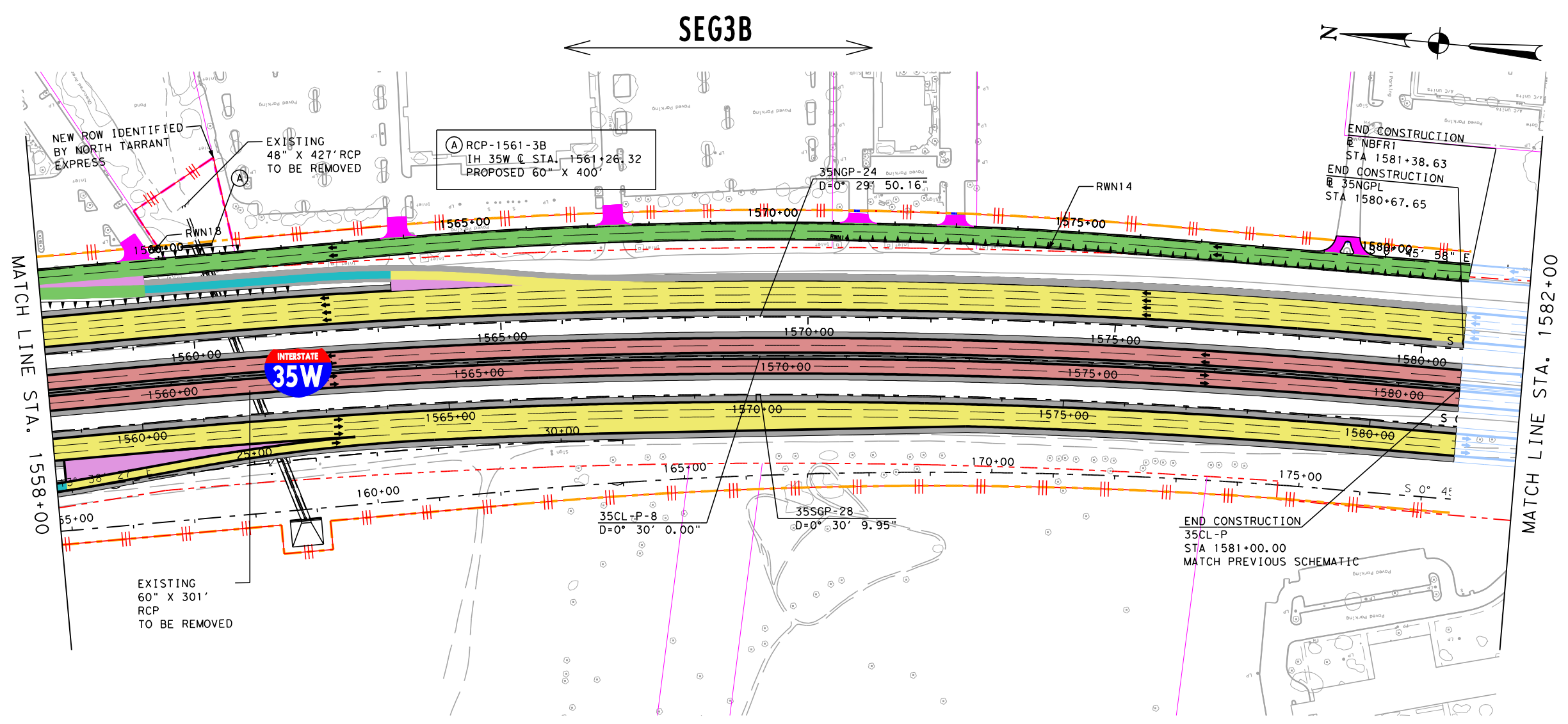

PRELIMINARY

north tarrant
express

AECOM
AECOM Technical Services Inc. - 3580

THIS DOCUMENT IS RELEASED UNDER THE AUTHORITY OF:
Fernando Gaytán, P.E.
TEXAS REGISTRATION NO: 92244
DATE: 7/8/2010
NOT TO BE USED FOR CONSTRUCTION, OR PERMIT PURPOSES.

NORTH TARRANT EXPRESS - SEGMENT 3B
IH 35W
PLAN

HORZ.: 1" = 200' SHEET 8A OF 9

FED. RD. DIV. NO.	PROJECT NUMBER	SHEET NO.	
STATE	DISTRICT	COUNTY	
TEXAS		TARRANT	
CONT	SECT	JOB	HIGHWAY NO
			IH 35W

NOTE: SHEET 8A OF 9
APPLICABLE ONLY WITH NTE
INTERCHANGE OPTION B

L:\work\Trans\112671 NTE\CADD (Segment 3A and 3B)\Seg3B\Sheets Inter\m\11x17\PLAN VIEW ONLY SHEETS FOR 051710 SUBMITTAL\Seg3B1+Schem\PLAN*08A.dwg 7/8/2010 5:00:27 PM

REV	DATE	BY	DESCRIPTION

LEGEND

- PROPOSED MAINLANES
- PROPOSED MANAGED LANES
- PROPOSED FRONTAGE ROADS / SURFACE STREET
- PROPOSED DIRECT CONNECTOR / PROPOSED RAMP
- PROPOSED SHOULDERS
- POTENTIAL DISPLACEMENTS
- PROPOSED GORE
- PREVIOUS CONSTRUCTION BY OTHERS
- PROPOSED RETAINING WALL
- PROPOSED NOISE WALL
- PROPOSED CONTROL-OF-ACCESS
- EXISTING RIGHT-OF-WAY
- PROPOSED RIGHT-OF-WAY (ACCESS RESTRICTED)
- PROPOSED DRAINAGE EASEMENT
- ADDITIONAL RIGHT-OF-WAY
- STRUCTURE LIMITS AND BENTS / COLUMNS
- PROPOSED STRUCTURE
- SIDEWALK
- EXISTING PAVEMENT REMOVAL
- TRAFFIC DIRECTION
- MANAGED LANE TOLL GANTRY
- RAMP TOLL GANTRY
- HOV DECLARATION AREA
- 170W35S ALIGNMENT NAME
- BRIDGE IDENTIFIER

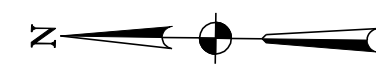

← SEG1A →

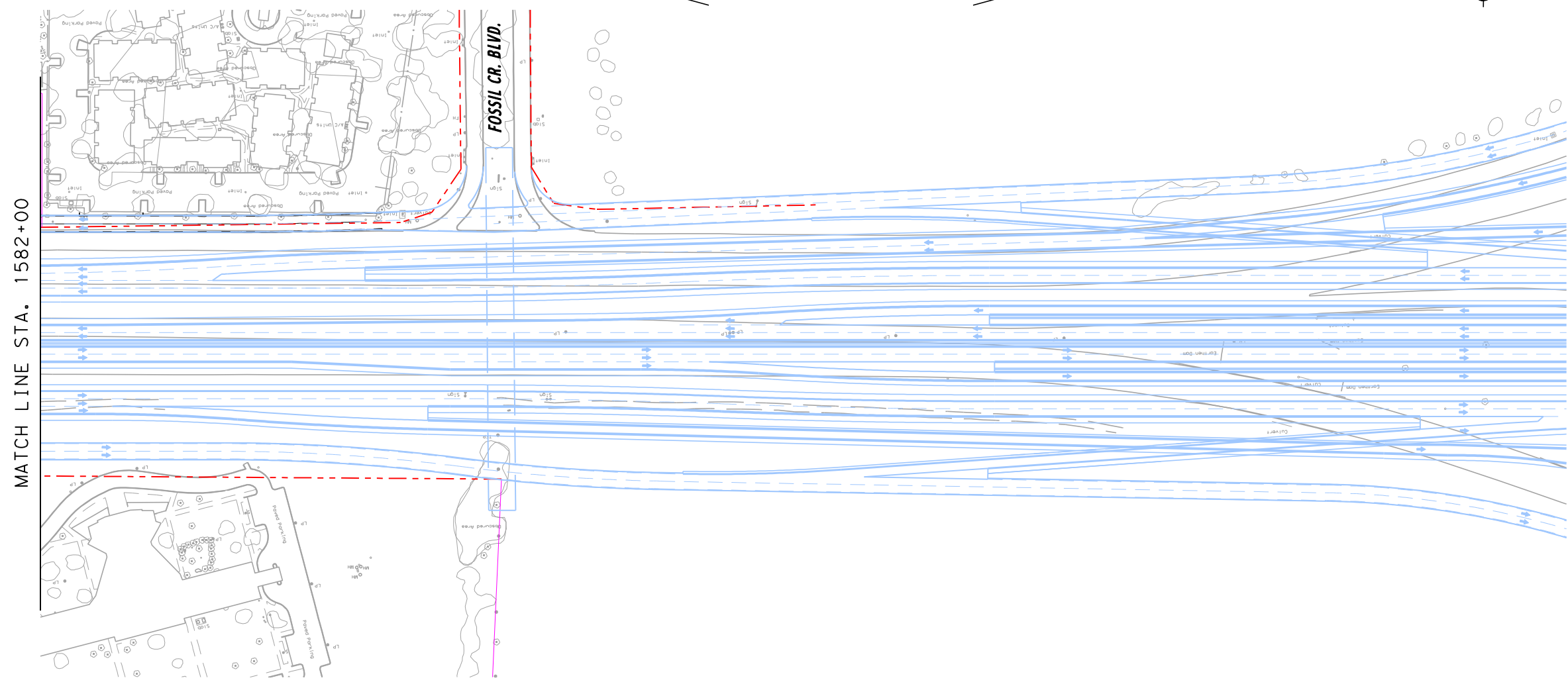

MATCH LINE STA. 1582+00

PRELIMINARY

north tarrant
express

AECOM
AECOM Technical Services Inc. - 3580

THIS DOCUMENT IS RELEASED UNDER THE AUTHORITY OF:
Fernando Gaytán, P.E.
TEXAS REGISTRATION NO: 92244
DATE: 7/8/2010
NOT TO BE USED FOR CONSTRUCTION, OR PERMIT PURPOSES.

NORTH TARRANT EXPRESS - SEGMENT 3B

**IH 35W
PLAN**

HORIZ.: 1" = 200'		SHEET 9 OF 9	
FED. RD. DIV. NO.	PROJECT NUMBER	SHEET NO.	
STATE	DISTRICT	COUNTY	
TEXAS		TARRANT	
CONT	SECT	JOB	HIGHWAY NO
			IH 35W

L:\work\Trans\112671 NTEX\CADD (Segment 3A and 3B)\Seg3B\Sheets Inter\m11x17\PLAN VIEW ONLY SHEETS FOR 051710 - SUBMITTAL\Seg3BIT\Schem\PLAN*09.dgn 7/8/2010 7:01:22 PM

REV	DATE	BY	DESCRIPTION

LEGEND

- PROPOSED MAINLANES
- PROPOSED MANAGED LANES
- PROPOSED FRONTAGE ROADS / SURFACE STREET
- PROPOSED DIRECT CONNECTOR / PROPOSED RAMP
- PROPOSED SHOULDERS
- POTENTIAL DISPLACEMENTS
- PROPOSED GORE
- PREVIOUS CONSTRUCTION BY OTHERS
- PROPOSED RETAINING WALL
- PROPOSED NOISE WALL
- PROPOSED CONTROL-OF-ACCESS
- EXISTING RIGHT-OF-WAY
- PROPOSED RIGHT-OF-WAY (ACCESS RESTRICTED)
- PROPOSED DRAINAGE EASEMENT
- ADDITIONAL RIGHT-OF-WAY
- STRUCTURE LIMITS AND BENTS / COLUMNS PROPOSED STRUCTURE
- SIDEWALK
- EXISTING PAVEMENT REMOVAL
- TRAFFIC DIRECTION
- MANAGED LANE TOLL GANTRY
- RAMP TOLL GANTRY
- HOV DECLARATION AREA
- ALIGNMENT NAME
- BRIDGE IDENTIFIER

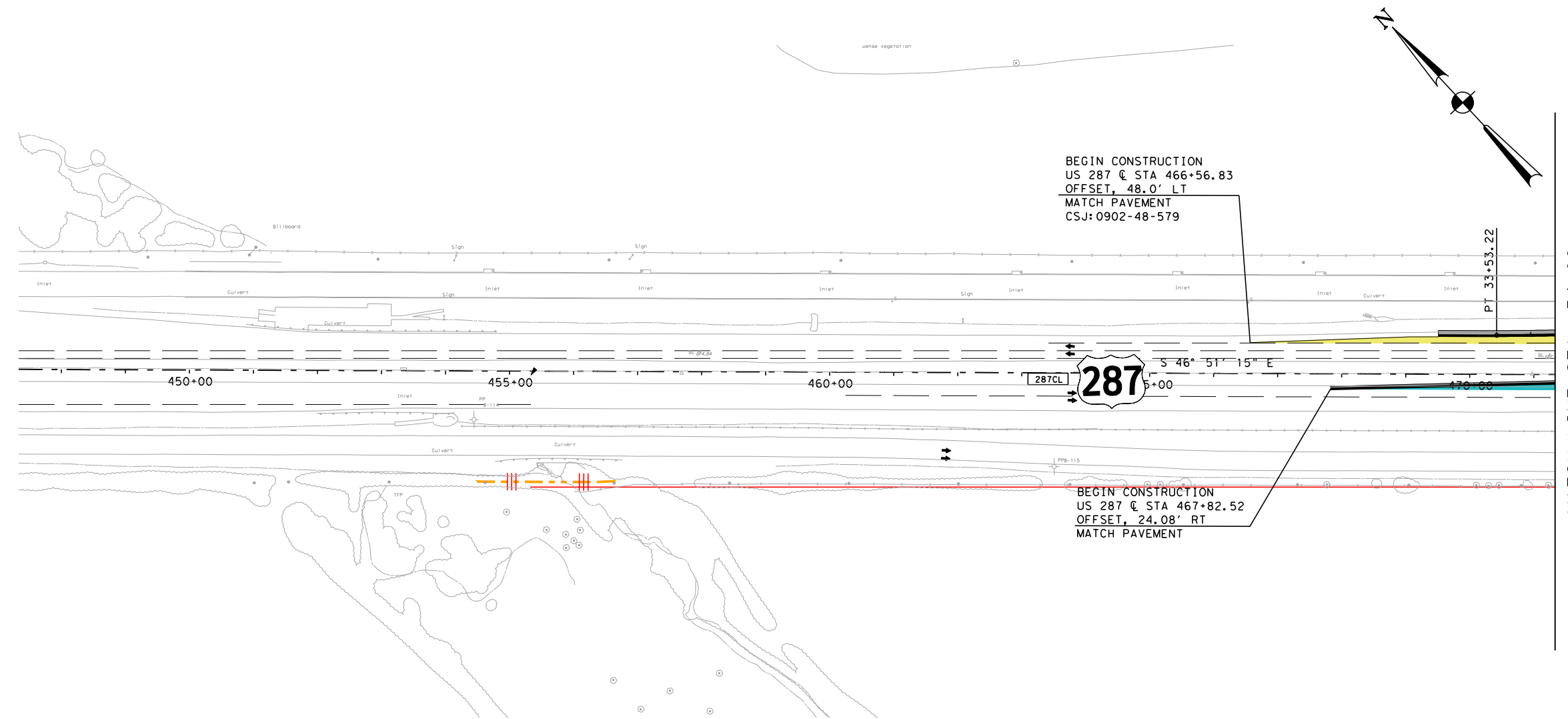

BEGIN CONSTRUCTION
 US 287 @ STA 466+56.83
 OFFSET, 48.0' LT
 MATCH PAVEMENT
 CSJ: 0902-48-579

BEGIN CONSTRUCTION
 US 287 @ STA 467+82.52
 OFFSET, 24.08' RT
 MATCH PAVEMENT

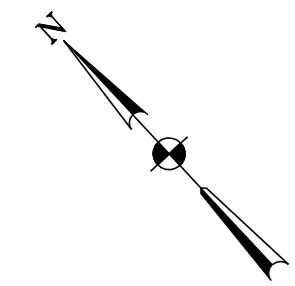

MATCH LINE STA. 34+00

PRELIMINARY

north tarrant
express

AECOM
 AECOM Technical Services Inc. - 3580

THIS DOCUMENT IS RELEASED UNDER THE AUTHORITY OF:
 Fernando Gaytán, P.E.
 TEXAS REGISTRATION NO: 92244
 DATE: 7/8/2010
 NOT TO BE USED FOR CONSTRUCTION, OR PERMIT PURPOSES.

NORTH TARRANT EXPRESS - SEGMENT 3B
 US287
 PLAN & PROFILE

HORZ.: 1" = 200' SHEET 1 OF 2

FED. RD. DIV. NO.	PROJECT NUMBER	SHEET NO.
STATE	DISTRICT	COUNTY
TEXAS		TARRANT
CONT	SECT	JOB
		HIGHWAY NO
		IH 35W

L:\work\Trans\112671 NTE\CADD (Segment 3A and 3B)\Seg3B\Sheets Inter\m11x17\PLAN VIEW ONLY SHEETS FOR 051710 SUBMITTAL\Seg3B1+Schem+PLAN*10.dgn 7/8/2010 7:04:58 PM

REV	DATE	BY	DESCRIPTION

LEGEND

- PROPOSED MAINLANES
- PROPOSED MANAGED LANES
- PROPOSED FRONTAGE ROADS / SURFACE STREET
- PROPOSED DIRECT CONNECTOR / PROPOSED RAMP
- PROPOSED SHOULDERS
- POTENTIAL DISPLACEMENTS
- PROPOSED GORE
- PREVIOUS CONSTRUCTION BY OTHERS
- PROPOSED RETAINING WALL
- PROPOSED NOISE WALL
- PROPOSED CONTROL-OF-ACCESS
- EXISTING RIGHT-OF-WAY
- PROPOSED RIGHT-OF-WAY (ACCESS RESTRICTED)
- PROPOSED DRAINAGE EASEMENT
- ADDITIONAL RIGHT-OF-WAY
- STRUCTURE LIMITS AND BENTS / COLUMNS PROPOSED STRUCTURE
- SIDEWALK
- EXISTING PAVEMENT REMOVAL
- TRAFFIC DIRECTION
- MANAGED LANE TOLL GANTRY
- RAMP TOLL GANTRY
- HOV DECLARATION AREA
- 170W35S ALIGNMENT NAME
- BRIDGE IDENTIFIER

NOTE:
 CURVE 35S-287-2 SHALL HAVE A DESIGN SPEED OF 40 MPH AS REQUIRED BY THE NORTH TARRANT EXPRESS MDP CDA GEOMETRIC DESIGN CRITERIA NOTE 19.

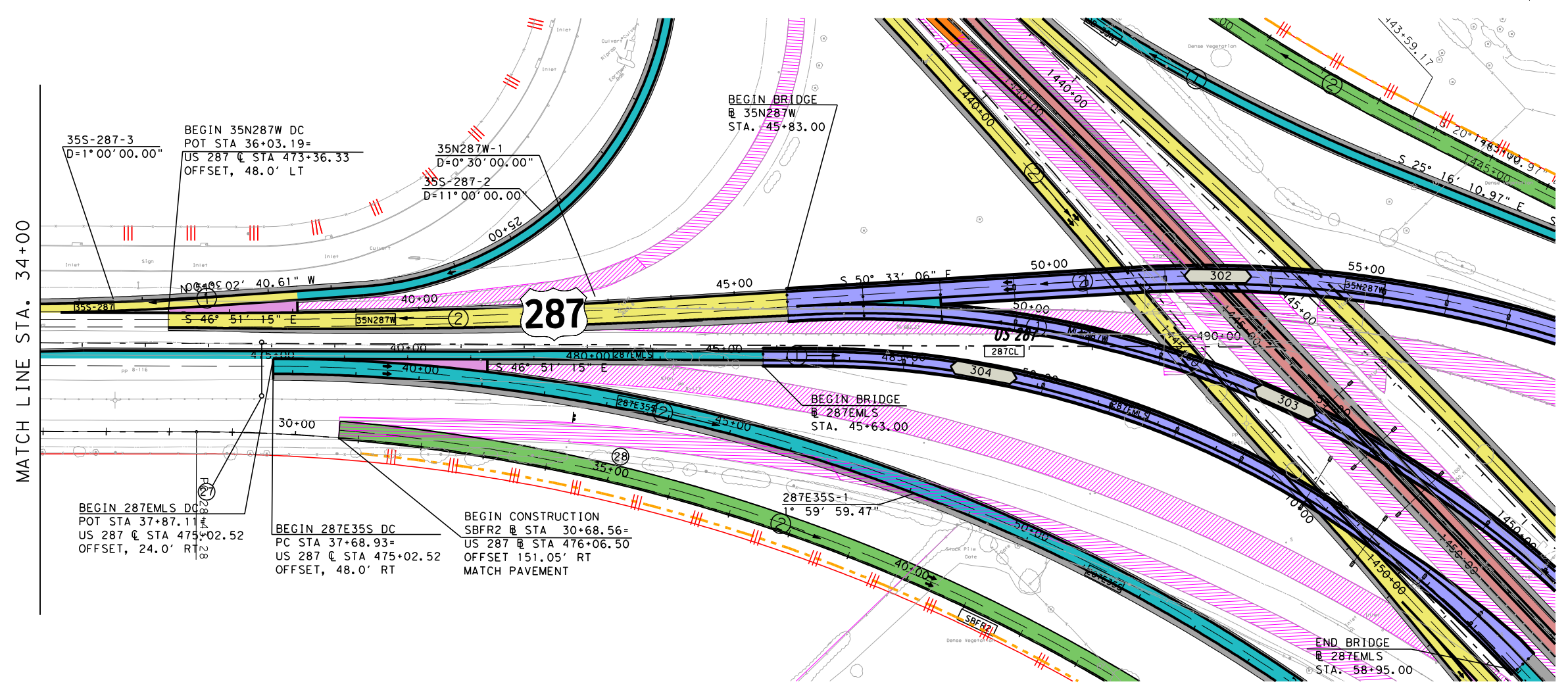
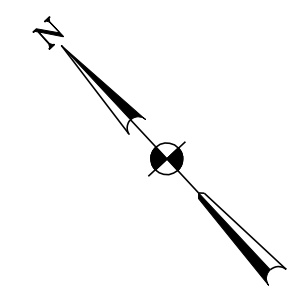

PRELIMINARY

north tarrant
express

AECOM
 AECOM Technical Services Inc. - 3580

THIS DOCUMENT IS RELEASED UNDER THE AUTHORITY OF:
 Fernando Gaytán, P.E.
 TEXAS REGISTRATION NO: 92244
 DATE: 7/8/2010
 NOT TO BE USED FOR CONSTRUCTION, OR PERMIT PURPOSES.

NORTH TARRANT EXPRESS - SEGMENT 3B

US287
PLAN & PROFILE

HORZ.: 1" = 200' SHEET 2 OF 2

STATE		DISTRICT		COUNTY	
TEXAS		TARRANT		TARRANT	
CONT	SECT	JOB	HIGHWAY NO	IH 35W	

L:\work\Trans\112671 NTE\CADD (Segment 3A and 3B)\Seg3B\Sheets Inter\m11x17\PLAN VIEW ONLY SHEETS FOR 051710 SUBMITTAL\Seg3B1*Scheme*PLAN*11.dgn 7/8/2010 4:57:35 PM